



# SYSTEM A2 model C14

## 1-COMPONENT ADVANCED BATCH SCALE



SYSTEM A2 model C14 controller

The SEG System A2-C14 is the most advanced batch controller in the A2-C.. series. It has a number of special batch features to improve speed and accuracy of batching. Model C14 is designed for tough environments acting as a stand-alone unit or via remote control. Versions for panel mount and wall mounting available.

### **Benefits**

- 24vdc power supply (230vac optional)
- 4-20mA isolated output (Gross weight)
- RS-485 serial port (RS-232 connection for printer only)
- Modbus (RTU, ASCII)
- 2x16 character text display with Backlight
- 4 Relay Outputs for batch control
- Permanently stored data in flash memory
- Real-time clock

### **Features**

- Indication of weight and batch states
- Stand alone or Remote operation
- Automatic batch printout
- Inputs for remote start etc.
- Easy to use start-up and re-calibration procedures
- Optional fieldbus connection; Profibus, CANopen, Devicenet etc.

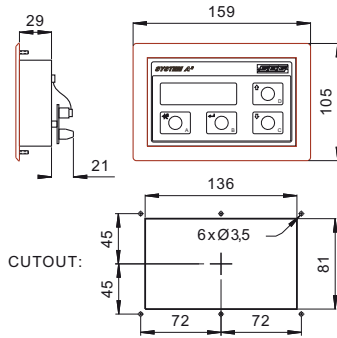

**Panel mount, type -P**  
weight: 0,5kg

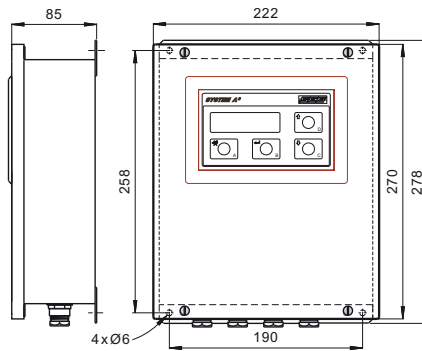
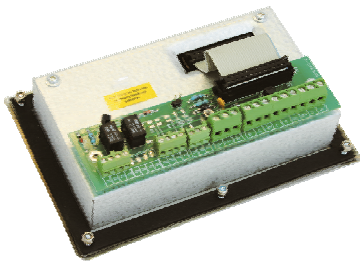

**Field enclosure type -W**  
weight: 3,0kg

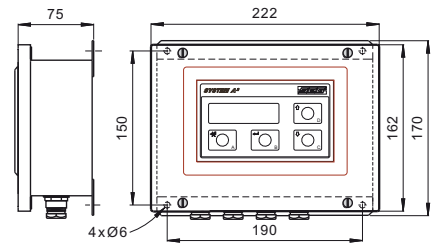
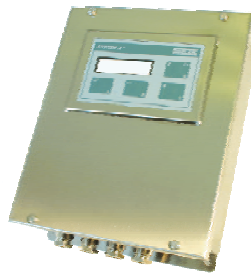

**Field enclosure type -V**  
weight: 2,5kg

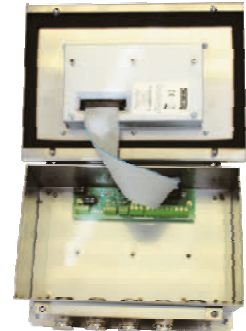

### Design

Frontpanel: Stainless steel frame with integrated keypad.  
Protection: Splashproof NEMA 4 / IP65.

Rear cover: Aluminium-zink metal.  
Protection: IP55.

**Field enclosures:** Stainless steel SIS2333.  
Protection: NEMA 4 / IP65.  
Cable entry: 4 x dia.19 holes w. PG11 metal glands,  
1 x dia. 22,5 hole.

### Display & control

Display: LCD 2x16 character, 5,5mm w. backlight.  
Control: 4-key local keypad or via RS485 com port.  
Memory: Battery back-up + Non-volatile FLASH memory.  
Set-up: Interactive via local keypad software.

### Power supply

Standard: 24Vdc, 5W.  
Protection: Fuse (internal)  
Optional: External 90-250VAC / 24VDC (PW-24).

### Connection

Terminal strip: 12 x 2,5 mm<sup>2</sup> max (AWG 16)  
for stranded wire. (Terminals: 1-6, V+, V-).  
11 x 1,5 mm<sup>2</sup> max (AWG 18)  
for stranded wire. (Terminals: 21-52).

### Input

Load Cell: 4- or 6-wire system with sense inputs, 0,3-45mVdc  
Digital (2) Closing contact. Start of batch. Ack. of deviation.

### Output

Load Cell, Exc.: 12Vdc nominal  
Max. load: 140 mA (~85 Ω)  
Min. load: 1000 Ω  
Relays (4): Dry contact N.O. 24Vdc / 1A.  
(Coarse-, Fine feed, Emptying and Ready for start.)  
Analog: Isolated 4-20mA, max 350Ω, 12-bit resolution.  
(Gross weight)

### Communication port

Port (1): RS485, Modbus RTU, ASCII

### Environmental

Location: Indoor/outdoor  
Operation: -10 to +50 °C  
Storage: -20 to +70 °C

### Approvals



EN 61000-4-3 (2006) and EN 55022 (1998) + A1 +A2



2002/95/EC - RoHS



Marking of electrical and electronic equipment in accordance with Directive 2002/96/EC (WEEE)

### ORDER INFO

**A2-N-4-P-C14-xx\*** System A2, normal Class, 4 relays, panelmounting, model C14 batch scale.  
**A2-N-4-W-C14-xx\*** System A2, normal Class, 4 relays, with enclosure type -W for wallmounting, model C14 batch scale.  
**A2-N-4-V-C14-xx\*** System A2, normal Class, 4 relays, with enclosure type -V for wallmounting, model C14 batch scale.

**-xx\*** Language selection: -GB or -S. Other languages to come.

**PW-24** Optional power supply, 90-250VAC/24VDC 25W. Fits inside field enclosure type -V and -W.  
**FB-zz** Optional fieldbus converters, -PDP (Profibus), -CAN (Canopen) etc. Fits inside field enclosure type -W only.  
**TB-230** Optional terminal board with 250VAC/3A output relays. (Direct replacement for existing terminal board).